

**GULF COAST
COMMUNITY COLLEGE**
Panama City, Florida

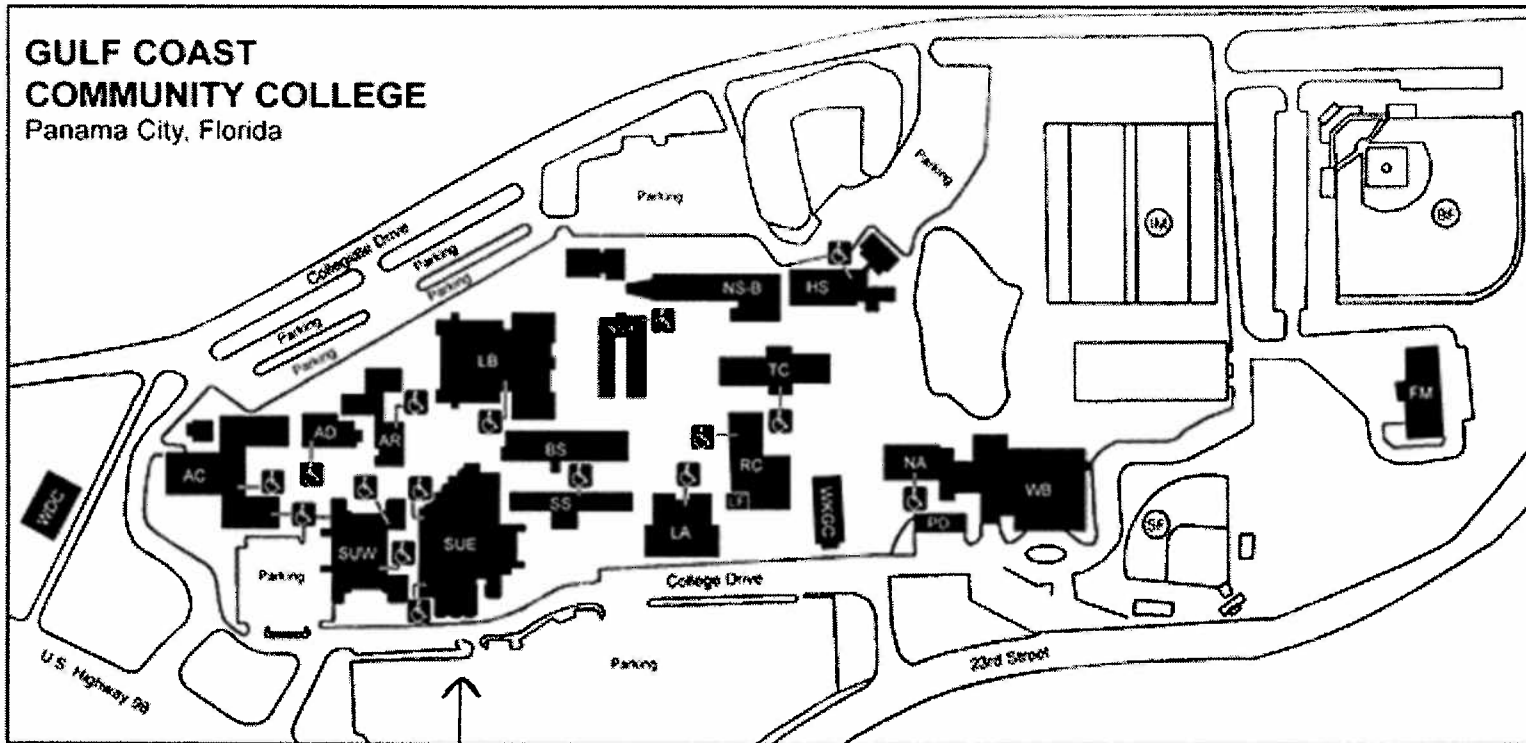

*Hathaway
Bridge
to Naval
Base*

Directory

Classroom Sites

- AC -- Amelia G. Tapper Center for the Arts
- BS -- J.R. Asbell Business Building
- HS -- George G. Tapper Health Sciences Building
- LA -- The Russell C. Holley and Herbert P. Holley Language and Literature Building/Sarzin Lecture Hall
- LB -- Library
- LF -- La Friandise
- NA -- Natatorium/Pool
- NS-A -- Natural Sciences Labs/Offices
- NS-B -- Natural Sciences Classrooms/Ken Sherman Science Center
- PD -- Professional Development Center
- RC -- Rosenwald Junior College Classroom Building
- SS -- Social Sciences Building
- SUE -- Student Union East/Gibson Lecture Hall
(Student Development/Center for Business, Continuing, and Community Education)
- SUW -- Student Union West
(Bookstore/Mathematics/Success Center)

- TC -- Technology Building
- WB -- Wellness Building/Billy Harrison Field House
- WDC -- Workforce Development Center
- WKGC -- WKGC-AM/FM Studios

Administrative Sites

- AD -- Administration Building
- AR -- Admissions & Records Building/
Gardner Seminar Room
- FM -- Facilities Management

Sport Complexes

- SF -- Softball/Joe Tom King Field
- IM -- Intramural Field
- BF -- Baseball/Bill Frazier Field

Ⓜ Automatic Doors for Disabled

STUDENT UNION - 1ST FLR
East

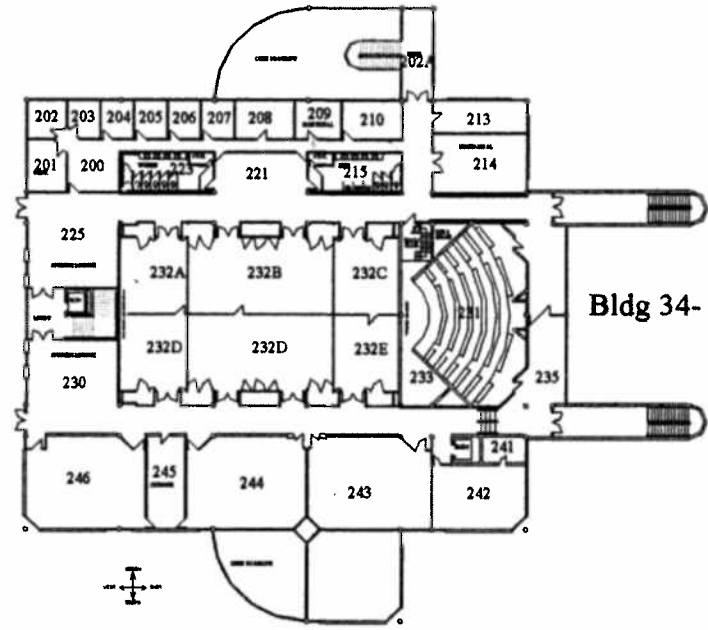
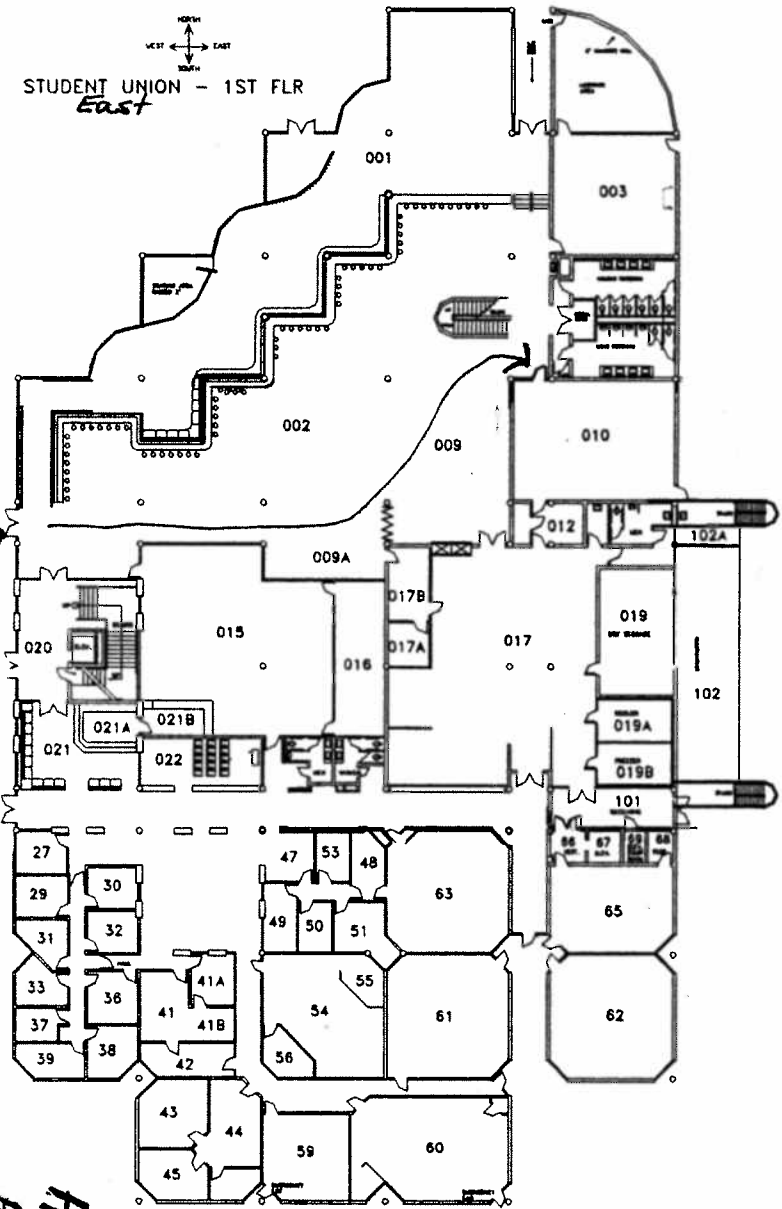

Bldg 34- Student Union, 2nd Fl

Main Campus Bldg 34E - Student Union *East Bldg*.

Student Union 110 ft. Rldg

Burgess

May 98
Parking lot